

**Simple to use:**

- Select the correct groove. Grooves marked with the recommended cable size
- Place the cable in the groove to be used  
Note: The arrow on the top of the tool indicates the pulling direction and the line indicates the blade location
- To slit the cable, close the tool making sure lock is engaged and pull
- For ring operation use ring side of tool and repeat steps above, instead of pulling rotate the tool 3-6 times to ring the cable



These **PATENTED** slit and ring tools are designed to open fiber jackets and loose buffer tubes to provide easy fiber access. One side of the tool slits fiber jackets and loose buffer tubes, the opposite side rings fiber jackets and loose buffer tubes. All this is done without damage to the fiber. Blades are replaceable. Note: MS-326 is designed for cables used in ducts and microducts.

SPECIFICATIONS	MS-526	MS-426	MS-336	MS-326	MS-316	MS-306
<b>DESCRIPTION</b>	Mid Span Slit & Ring Tool (9.8 mm-18.2 mm)	Mid Span Slit & Ring Tool (5.8 mm-12 mm)	Mid Span Slit & Ring Tool (7.9 mm-11 mm)	Mid Span Slit & Ring Tool (5 mm-10 mm)	Mid Span Slit & Ring Tool (2.9 mm-6.8 mm)	Mid Span Slit & Ring Tool (1.2 mm-3.3 mm)
<b>NO. OF PRECISION GROOVES</b>	8 (4 Slitting, 4 Ringing)	8 (4 Slitting, 4 Ringing)	4 (2 Slitting, 2 Ringing)	10 (5 Slitting, 5 Ringing)	10 (5 Slitting, 5 Ringing)	12 (6 Slitting, 6 Ringing)
<b>GROOVE SIZES</b>	9.8-10.2 mm   11.8-12.2 mm   15.4-15.8 mm   17.8-18.2 mm	5.8-6.4 mm   7.8-8.4 mm   9.8-10.4 mm   11.2-12 mm	7.9-8.2   10.7-11.0 mm	5.0-5.6 mm   6.0-6.6 mm   7.2-7.8 mm   7.8-8.4 mm   9.4-10 mm	2.9-3.6 mm   3.6-4.4 mm   4.4-5.2 mm   5.2-6.0 mm   6.0-6.8 mm	1.2-1.5 mm   1.5-1.8 mm   1.8-2.1 mm   2.1-2.5 mm   2.5-2.9 mm   2.9-3.3 mm
<b>CABLE DIAMETERS</b>	9.8 mm-18.2 mm	5.8 mm-12 mm	7.9 mm-11 mm	5 mm-10 mm	2.9 mm-6.8 mm	1.2 mm-3.3 mm
<b>CABLE TYPE</b>	Corning Altos® with FastAccess®	Thick-walled jackets (up to 2.0 mm thick)	Corning's Minixtend HD 288 and 432	Thin-walled Jackets	Outer Jackets, Loose Buffer Tubes	Outer Jackets, Loose Buffer Tubes

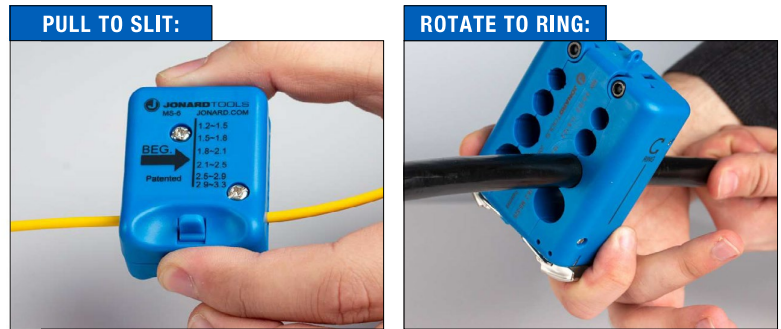

SPECIFICATIONS	MS-6	MS-26
<b>DESCRIPTION</b>	Mid Span Slitter (1.2 mm-3.3 mm)	Mid Span Slitter (2.9 mm-6.8 mm)
<b>NO. OF PRECISION GROOVES</b>	6	5
<b>GROOVE SIZES (MM)</b>	1.2-1.5 mm   1.5-1.8 mm   1.8-2.1 mm   2.1-2.5 mm   2.5-2.9 mm   2.9-3.3 mm	2.9-3.6 mm   3.6-4.4 mm   4.4-5.2 mm   5.2-6.0 mm   6.0-6.8 mm
<b>CABLE DIAMETERS</b>	1.2 mm-3.3 mm	2.9 mm-6.8 mm
<b>CABLE TYPE</b>	Outer Jackets, Loose Buffer Tubes	Outer Jackets, Loose Buffer Tubes

REPLACEMENT CARTRIDGES	JONARD PART #	DESCRIPTION
	<b>MSB-1533</b>	Replacement Blades for MS-6
	<b>MSB-2968</b>	Replacement Blades for MS-26
	<b>MS-306RB</b>	Replacement Blades for MS-306
	<b>MS-316RB</b>	Replacement Blades for MS-316
	<b>MS-336RB</b>	Replacement Blade Set for MS-336
	<b>MSB-5010</b>	Replacement Blades for MS-326
	<b>MS-426RB</b>	Replacement Blades for MS-426
	<b>MS-526RB</b>	Replacement Blades for MS-526

## MID SPAN SLIT & RING TOOL INSTRUCTIONS

These **PATENTED** slit and ring tools are designed to open fiber jackets and loose buffer tubes to provide easy fiber access. One side of the tool slits fiber jackets and loose buffer tubes, the opposite side rings fiber jackets and loose buffer tubes. All this is done without damage to the fiber. Blades are replaceable. Note: Thin walled cables are designed for cables used in ducts and microducts.

### Simple to use:

- Select the correct groove. Grooves marked with the recommended cable size
- Place the cable in the groove to be used  
Note: The arrow on the top of the tool indicates the pulling direction and the line indicates the blade location
- To slit the cable, close the tool making sure lock is engaged and pull
- For ring operation use ring side of tool and repeat steps above, instead of pulling rotate the tool 3-6 times to ring the cable

### MID SPAN SLITTING EXAMPLE:



### MID SPAN RINGING EXAMPLE:

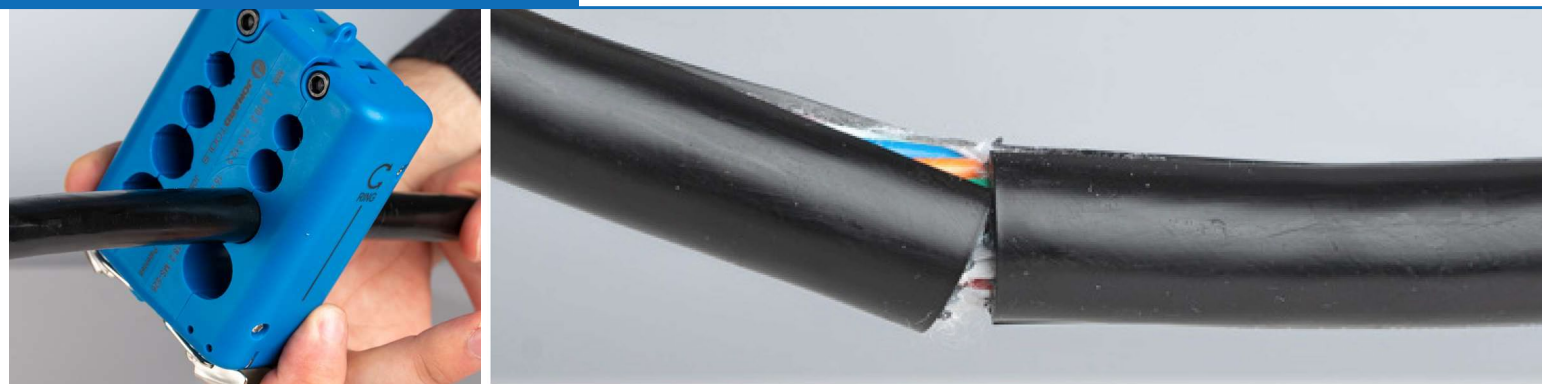

[www.specialized.net](http://www.specialized.net)

Debbi Kosakowski - National Sales Manager • [dkosakowski@specialized.net](mailto:dkosakowski@specialized.net) • 727-515-0911  
Eleanor Barszowski - NE Regional Sales Manager • [ebarszowski@specialized.net](mailto:ebarszowski@specialized.net) • 484-955-3178  
Carolyn Thompson - CSR Midwest/SE • [carolyn@specialized.net](mailto:carolyn@specialized.net) • 813-295-9889  
Becca Bowman - CSR NE/Western • [bbowman@specialized.net](mailto:bbowman@specialized.net) • 727-412-1591